

# SafetyGrip® StepAssist™ GRAB BAR

SG778 or SG779

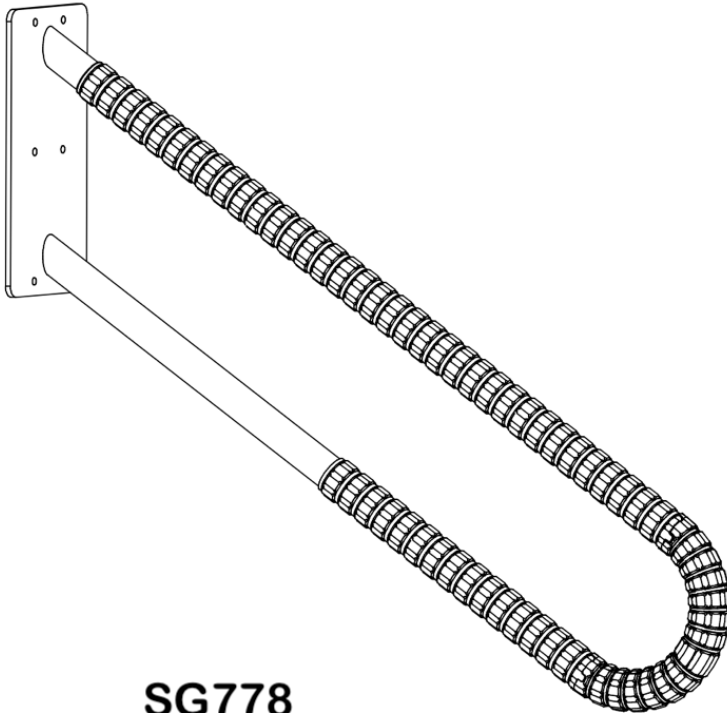

**SG778**

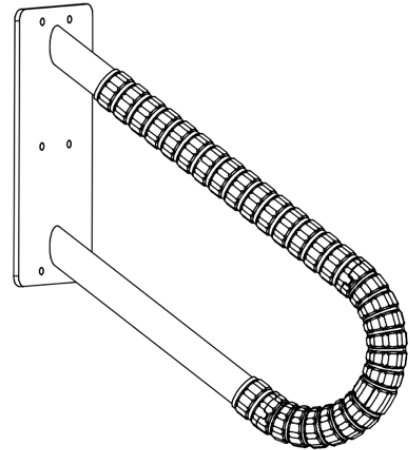

**SG779**

## Table of Contents

- Warnings and Cautions for SG778 & SG779 (1 Page)
- SG778 & SG779 Grab Bars Installation Instruction (4 Pages)

## Specifications:

- Product Name: SafetyGrip® StepAssist™ Grab Bar
- Product#: SG778 & SG779

## KIT CONTENTS

**THIS KIT HAS ONE OF SG778 or ONE OF SG779**

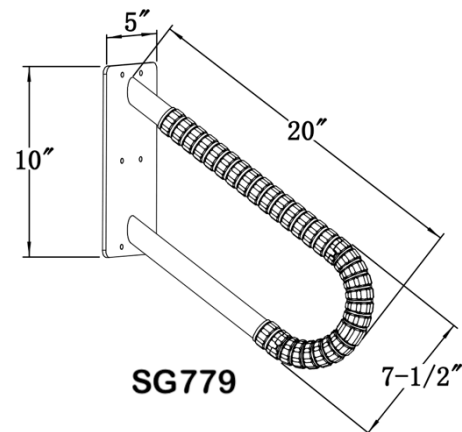
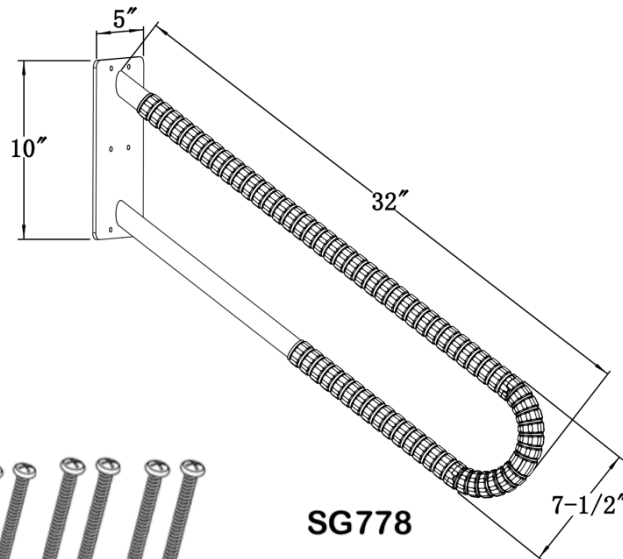

**#14 WOOD SCREWS**

## Tools Required

- Stud Finder
- Safety Glasses
- Power Drill
- Tape Measure
- 1/8 inch drill bit for pilot holes for the wood screws
- Philips screw driver
- Pencil

## TECHNICAL DATA

Safety and pleasing designs to enhance your bathroom décor, and will increase your safety in your home.

- All Hartmobility SafetyGrip® Grab Bars are ADA Compliant and will support up to 350 lbs when installed correctly onto door jambs or walls that structurally sound and strong..
- They feature our patented interlocking SafetyGrip® for the safest available grip.
- They come with the long-lasting protection of embedded antimicrobial AlphaSan® RC5000 silver ions powder for all parts. For more details about AlphaSan®: <https://www.milliken.com/en-us/businesses/chemical/product/alphasan>



**WARNING: FALL HAZARD.** Attach the grab bar securely to the wall. Failure to do so could result in death or serious injury.

## INSTALLATION

### STEP 1: Cut The Door Jamb Trim Strip

- First put on Safety glasses. Mark where the wall studs are.
- Decide which side of your doorway that you want to mount this product on.



- Mark the door jamb where you want to mount this product. We recommend a height above your step of between 32" and 36".
- This height can be adjusted to suit the height of the user.
- Cut the door jamb trim strip to allow this product to be mounted flush to the wall.

RIGHT SIDE INSTALLATION SHOWN  
LEFT SIDE OPPOSITE

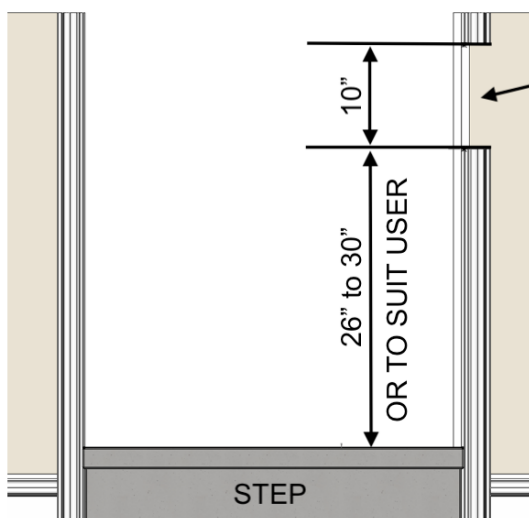

VIEW of DOORWAY

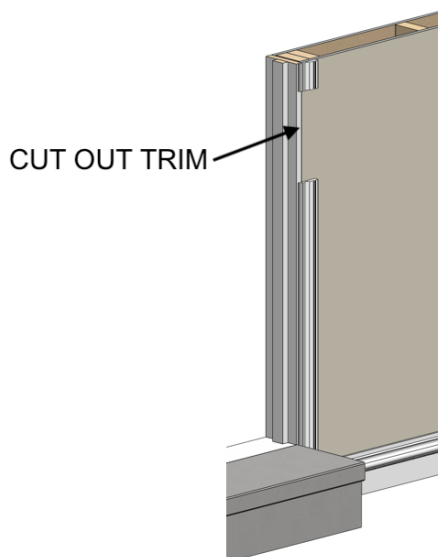

SIDE VIEW SHOWING  
CUT OUT TRIM

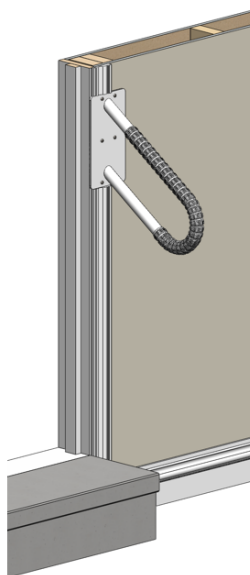

SIDE VIEW SHOWING  
SG779 INSTALLED

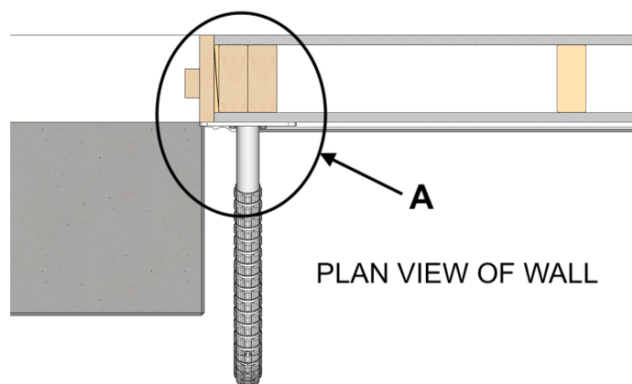

PLAN VIEW OF WALL

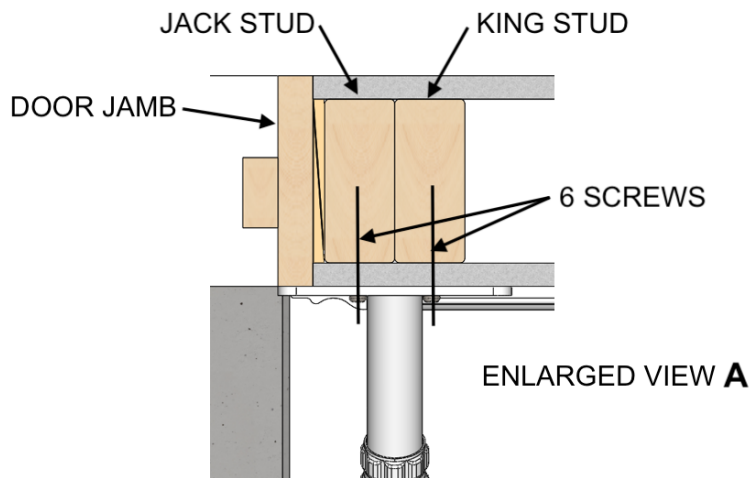

ENLARGED VIEW **A**

## STEP 2:

Put your product against the wall where you have cut away the door jamb trim strip and mark the holes.

Drill the 1/8 inch pilot holes into the two doorway studs.

Securely screw the product to the wall using the screws provided in this kit.

**NOTE:** if your doorway is using steel studs you must use the appropriate fasteners. Not supplied in this kit.

## Maintenance and Cleaning

- **VERY IMPORTANT:** It is important to inspect the Product(s) frequently.
- Stop using immediately if damaged or broken, or if parts are missing.
- Stop using immediately if Product(s) shift out of the original installed position(s) until they are readjusted into the correct position.
- To clean, use a damp cloth with soap and water or mild household cleaner, wipe clean and dry before using.

## Warranty

For Warranty details, refer to the Warranty details on the Hartmobility Inc.

Website: [www.hartmobility.com/Warranty](http://www.hartmobility.com/Warranty) or call 1-800-998-0774 ext. 3

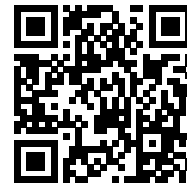

### Questions. Comments. Concerns.

Contact Customer Service today.

[info@SafetyGrip.com](mailto:info@SafetyGrip.com)

[www.SafetyGrip.com](http://www.SafetyGrip.com)

[www.Hartmobility.com](http://www.Hartmobility.com)

1(800) 998-0774

Hartmobility Inc.  
424 Williamson-Zebulon Rd.  
Williamson, GA 30292

Hartmobility reserves the right to update and revise our products. Refer to our website for the most up-to-date version of this document.

Copyright © 2025 Hartmobility Inc. All Rights Reserved.

