

SafetyGrip® ROTOBAR

SG601

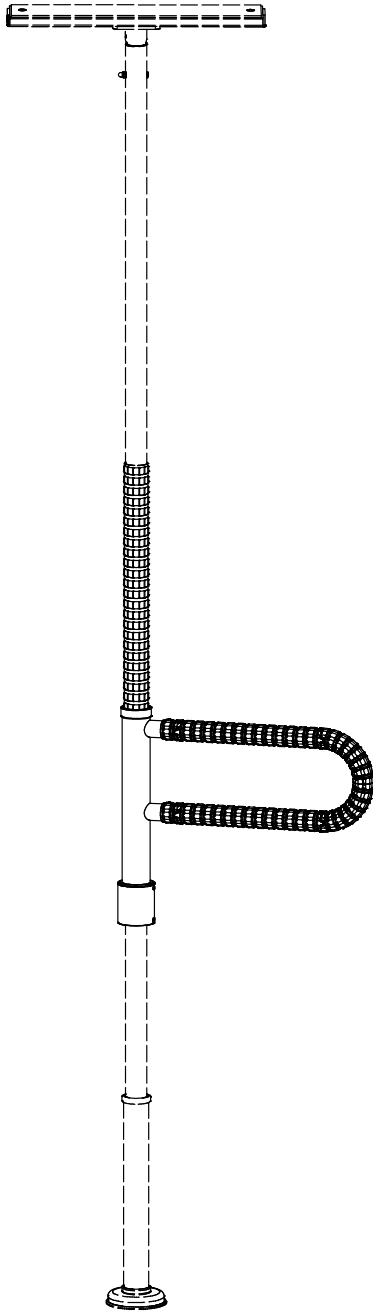

Table of Contents

- SG601 Installation Instruction (5 Pages)
- Warnings & Cautions for SG601 (1 Pages)

Specifications:

- Product Name: SafetyGrip® ROTOBAR
- Product#: SG601
- Maximum User Weight: 350lbs (158kg)

KIT CONTENTS

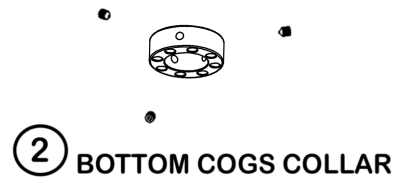
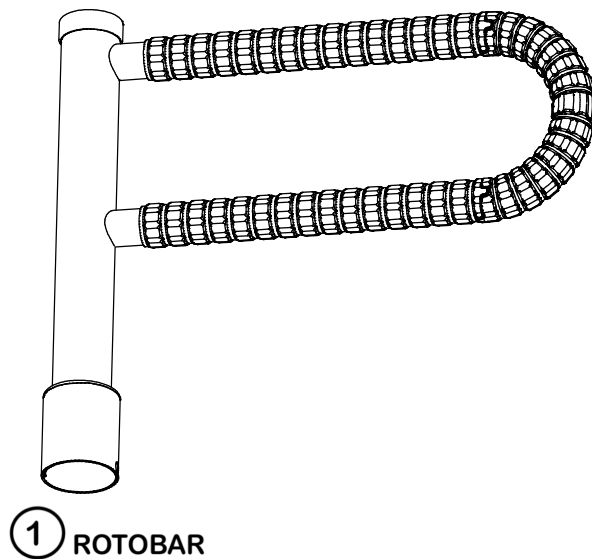

HEX KEY

PRODUCT INFORMATION

IMPORTANT:

- ◇ When installing this SG601 RotoBar on any Grab Poles it is **VERY IMPORTANT** to screw the Pole Ceiling Channel to the joists. The two screws are provided. Follow the instructions that came with the Poles on how to do this.
- ◇ If you are installing this SG601 RotoBar on a Grab Pole that is near a bed there must be a gap of at least 28 inches between the Pole and the nearest edge of the bed.
- ◇ **NOTE:** If the Pole Kit has a Safety Retention Strap discard this now, it will not be needed.
- ◇ When installing the SG601 there is always a risk of entrapment between it and furniture, fixtures and other objects.
- ◇ The SG601 is designed to assist with sit-up, reposition, balance, stand, transfer and stability for persons weighing up to 350lbs (158kg) and is **NOT** designed to bear the full weight of the user.

The Titan series feature our patented interlocking SafetyGrip® and the long-lasting protection of embedded antimicrobial AlphaSan® RC5000 silver ions powder for all parts except hardware.

For more details about AlphaSan®: <https://www.milliken.com/en-us/businesses/chemical/product/alphasan>



INSTALLATION

NOTES

1. If you purchased the SG601 RotoBar and the Grab Pole together follow the Steps 1 through 4 below.
2. If you already have the Grab Pole and it is installed you will need to loosen it and lay it on the floor. Remove the Base and remove the Bottom Cover Tube. Now follow Steps 1 through 4 below.

STEP 1: Slide the Rotating Grab Bar and parts onto the Pole

Slide the RotoBar assembly and the other parts onto the Grab Pole from the bottom.

Follow the sequence shown on the Step 1 drawing.

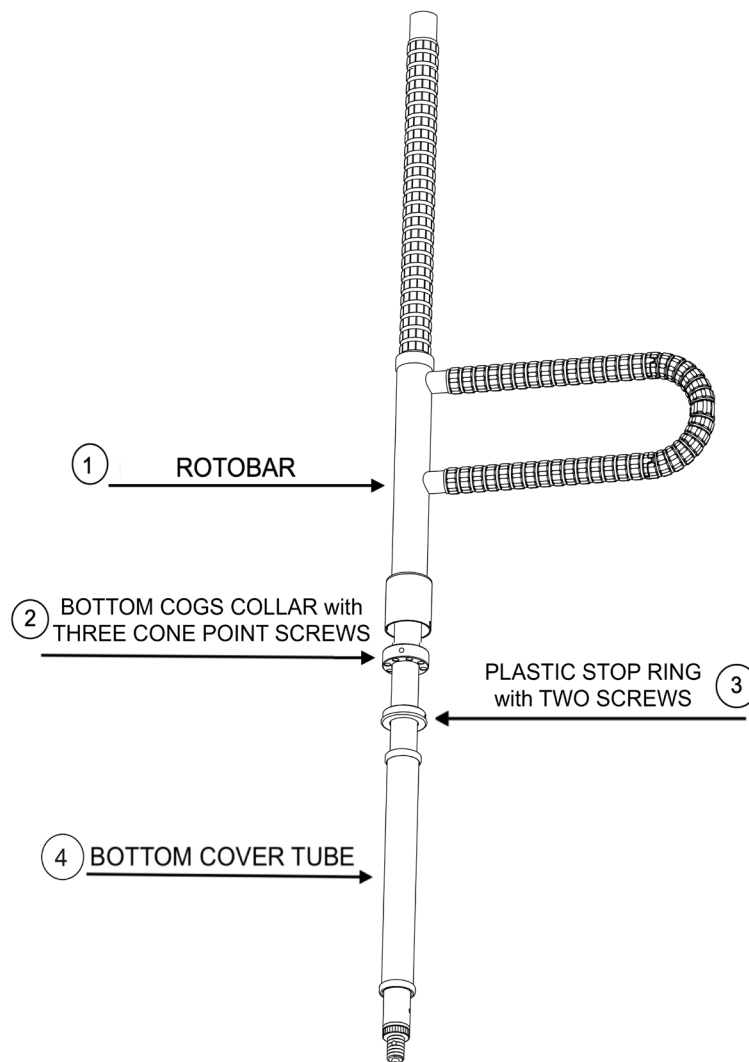

ASSEMBLY of PARTS SEQUENCE

STEP 1

STEP 2: Finish Installing the Pole

Finish installing the Grab Pole by following the Pole Assembly Instructions provided with the Grab Pole.

STEP 3: Decide how high you want the RotoBar

When the Grab Pole is assembled and standing between the floor and ceiling you can decide how high that you want the RotoBar to be from the floor. We suggest 32 inches from the lower grab bar to the floor. The upper grab bar will be 38 inches from the floor. These are good sit to stand heights. These heights can be adjusted to suit the user. Measure 26 inches from the floor and make a mark on the pole.

Move the Bottom Cogs Collar to this mark and securely tighten the 3 screws using the hex key provided.

Your lower grab bar will now be 32 inches from the floor.

STEP 4: Install the Plastic Stop

Install the Plastic Stop Ring into the bottom of the RotoBar with the two screws provided.

Test that the RotoBar lifts and rotates smoothly and drops down and looks securely in place.

MAINTENANCE

- **VERY IMPORTANT:** It is important to inspect the Product(s) frequently.
- Stop using immediately if damaged or broken, or if parts are missing.
- To clean your RotoBar, use a damp cloth with soap and water or mild household cleaner, wipe clean and dry before using.

Warranty

For Warranty details, refer to the Warranty details on the Hartmobility Inc.

Website: www.hartmobility.com/Warranty or call 1-800-998-0774 ext. 3



Hartmobility reserves the right to update and revise our products. Refer to our website for the most up-to-date version of this document.

Copyright © 2024 Hartmobility Inc. All Rights Reserved.





Questions. Comments. Concerns.

Contact Customer Service today.

info@SafetyGrip.com

www.SafetyGrip.com

www.Hartmobility.com

1(800) 998-0774

Hartmobility Inc.
424 Williamson-Zebulon Rd.
Williamson, GA 30292